

CR310

Remote Control

Quick Guide

- ✓ Getting started
- ✓ Quick reference



Hear now. And always



About

Use the Cochlear™ CR310 Remote Control to control the commonly used functions of your Cochlear Nucleus 7 Sound Processor (model number: CP1000).



NOTE

More information and warnings in the *CR310 Remote Control User Guide*.



WARNING

Swallowing Lithium batteries may lead to serious injury or death. If swallowed, immediately go to a hospital emergency room. Keep out of reach of children. Keep in original packaging until ready to use. Dispose of used batteries immediately.

CR310 Remote Control



Change battery

Change the battery whenever you see the low battery indicator.



1. Unscrew cover with a Phillips head (cross-head) screwdriver.



2. Remove cover and old battery.



CAUTION

Use **ONLY** disposable CR2032 or 5004LC 3V standard lithium coin cell batteries in your remote control.

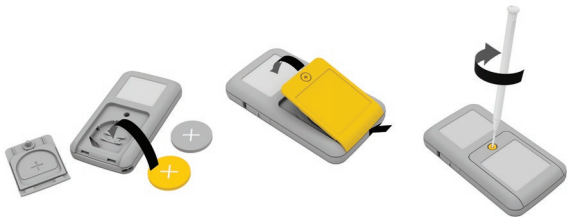

3. Carefully insert new battery, plus "+" side up.
4. Replace cover, bottom edge first.
5. Screw cover back on.

Turn on

Slide the switch
up to turn on.



Turn off

Slide the switch
down to turn off.



TURN ON

Pair

Pairing allows two devices to communicate with each other.



When display shows remote control is not paired:

1. Turn your processor and remote control **off**, then **on**.
2. Place the coil on the back of your remote control.



3. Remote control shows pairing in progress.



4. Remote control shows it's paired.



5. If you have a second processor, repeat steps 1–4.

Change programs



Adjust volume/sensitivity



Turn up either
volume or
sensitivity
(if available)

Turn down
volume or
sensitivity

Wireless accessories

When a Cochlear True Wireless™ Accessory (Mini Microphone or TV Streamer) is paired with your processor, use your remote control to start and stop streaming audio.

Display shows
wireless
accessory:



Start streaming:



Long-press once.

Stop streaming:



Short-press once.

FM accessory

When an FM accessory is connected to your processor, use your remote control to turn the accessory off and back on.

Display shows
FM accessory:



Turn FM
accessory off:



Short-press once.

Turn FM
accessory on:



Short-press once.

Telecoil

Listen to room loops with telecoil.

Turn telecoil on:



Short-press once.

Turn telecoil off:



Short-press once.

Care

Clean your remote control with a soft dry cloth.
Keep your remote control dry.



Hear now. And always



Cochlear Ltd (ABN 96 002 618 073)

1 University Avenue, Macquarie University, NSW 2109, Australia

Tel: +61 2 9428 6555 Fax: +61 2 9428 6352

Cochlear Ltd (ABN 96 002 618 073)

14 Mars Road, Lane Cove, NSW 2066, Australia

Tel: +61 2 9428 6555 Fax: +61 2 9428 6352

 **Cochlear Deutschland GmbH & Co. KG**

Karl-Wiechert-Allee 76A, 30625 Hannover, Germany

Tel: +49 511 542 770 Fax: +49 511 542 7770

Cochlear Americas

13059 E Peakview Avenue, Centennial, CO 80111, USA

Tel: +1 303 790 9010 Fax: +1 303 792 9025

株式会社日本コクレア (Nihon Cochlear Co Ltd)

〒113-0033 東京都文京区本郷2-3-7 お茶の水元町ビル

Tel: +81 3 3817 0241 Fax: +81 3 3817 0245

www.cochlear.com

Cochlear, Hear now. And always, Nucleus, and the elliptical logo are either trademarks or registered trademarks of Cochlear Limited.

© Cochlear Limited 2017

594632 ISS2 APR17